

Notes
1. All dimensions to be checked on site and any discrepancy to be verified with the Store Planner before proceeding with the work.
2. DO NOT SCALE FROM THIS DRAWING
3. Use this drawing for sales area fixtures and shopfitting. When referencing refrigeration cabinets use the latest CBES drawing. If the CBES drawing does not match this plan, please contact the Store Planner.
4. For all BOH areas please contact the Architect.
5. Exact position of all Bus Stop Signage to be positioned on site to suit the commodity as landed

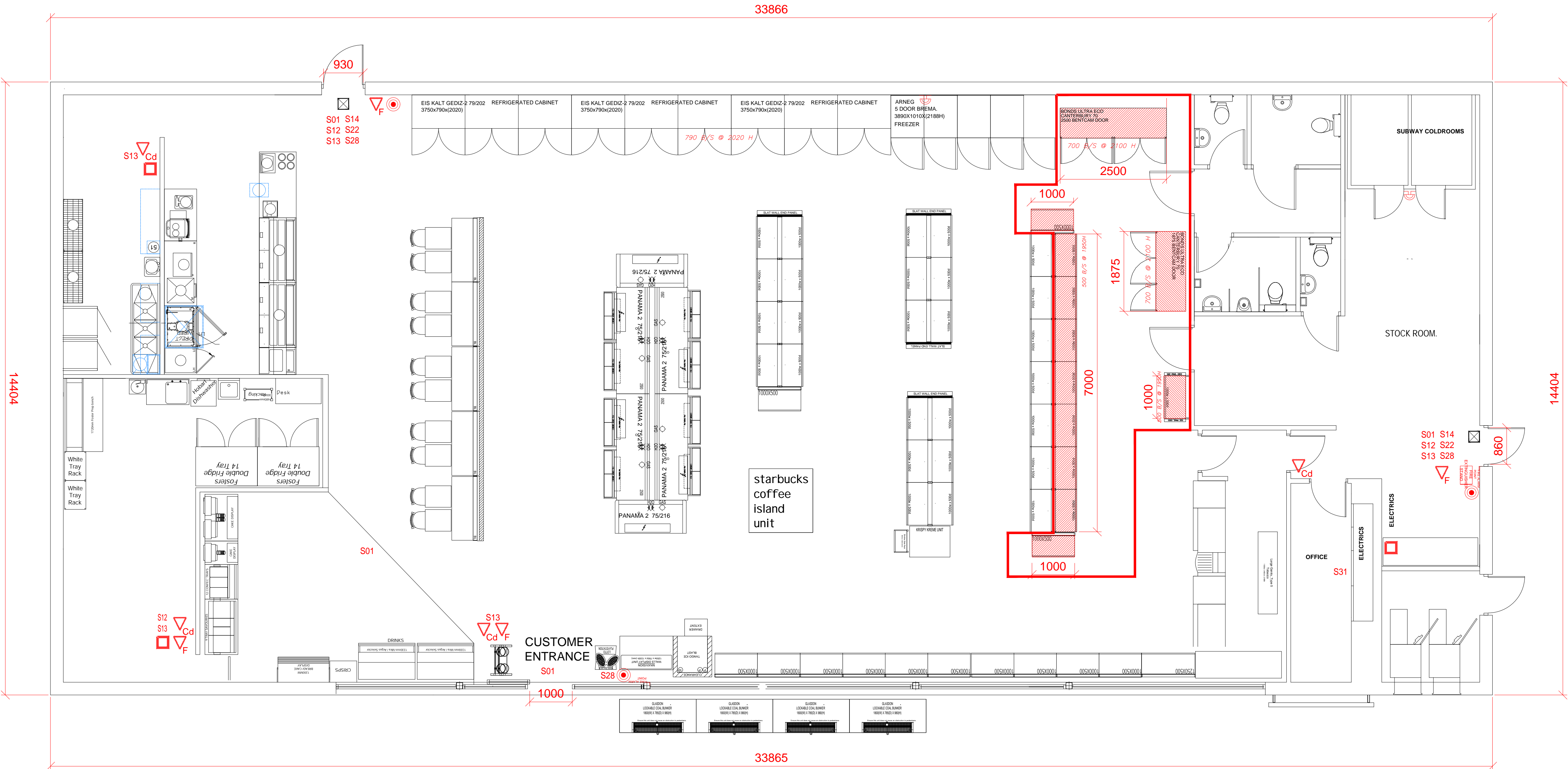

ADDITIONAL KIT TO BE ORDERED BY FM THAT IS NOT SHOWN ON PLAN
KIT TYPE BLOCK REFERENCE QUANTITY

Fire Escape Signage & Details

- S01 FE type 1 illuminated final exit sign
- S02 FE type 2 illuminated directional exit sign
- S03 FE type 3 illuminated directional exit sign
- S04 FE type 4 illuminated directional exit sign
- S05 FE type 5 illuminated directional exit sign
- S06 FE type 6 photoluminescent directional exit sign (suspended frame system, clips & hanging wires)
- S07 FE type 7 photoluminescent directional exit sign (self adhesive)
- S08 FE type 8 photoluminescent directional exit sign (self adhesive)
- S09 FE type 9 photoluminescent directional exit sign (self adhesive)
- S10 FE type 10 photoluminescent directional exit sign (self adhesive)
- S11 FE type 11 illuminated exit sign
- S12 Safety signs - fire action sign
- S13 Safety signs - fire extinguisher
- S14 Safety signs - push bar to open
- S20 Safety signs - fire exit
- S22 Safety signs - fire escape keep clear
- S25 Safety signs - fire door keep locked
- S28 Safety signs - fire alarm call point
- S31 Safety signs - fire door keep shut
- S18 Safety signs - min size 150 x 150 vinyl to bs 7036, pt 1 1996

- Break glass unit
- Emergency door release
- Sounder
- Fire blanket

Fire Extinguisher Identification

- CO2 CO2 extinguisher 5kg
- F Foam extinguisher 6 litres
- P Powder extinguisher
- W Water extinguisher 9 litre
- Cd Carbon dioxide extinguisher

Areas

- Denotes BWS on sales floor and lock up

Alcohol Display Frontage = 28.68 m²

Footage in m² of the BWS bags = 8.09m²

Footage in m² of the BWS department = 34m²

Liner footage of BWS = 14.37m

Names of surrounding streets:

- A82
- A813
- Lomondgate Drive

No. Date BY CHD COMMENTS



Store
LOMONDGATE EXPRESS

Scheme Type
BWS LICENCE APPLICATION

SOFT	REC	AMENDED	EXISTING	ACHIEVED
Food Net	SOFT	SOFT	2639 SOFT	SOFT
GM Net	SOFT	SOFT	SOFT	SOFT
George Net	SOFT	SOFT	SOFT	SOFT
Optical Net	SOFT	SOFT	SOFT	SOFT
Pharmacy Net	SOFT	SOFT	SOFT	SOFT
Phone Shop Net	SOFT	SOFT	SOFT	SOFT
Net Total	SOFT	SOFT	SOFT	SOFT
Policy 107	SOFT	SOFT	SOFT	SOFT
Planning Cap	NO	NO		

Gross Footage	Ratio	
Store Planner @ Asda	Store Planner @ Asda	
Direct Number	0113 826	
RCM Sponsor	RCM / Sponsor @ Asda	
SLM	SLM @ Asda	
CM	CM @ Asda	
PM	PM @ Company	
FM	FM @ Company	
George Planner	George Planner @ George	REV Rev
Architect	Paul Towers @ HGP	

Drawing Number
SP-GF-EX-5363

Floor
GROUND FLOOR

Issue For
BWS LICENCE APPLICATION

Scale
1:100

Date
11/02/2025

Feet	6'	6'6"	7'	7'6"	8'	8'6"	9	9'6"	10'	10'6"	11'	12'	13'	14'	15'	16'
mm	1830	2000	2100	2300	2400	2600	2700	2900	3000	3200	3300	3700	4000	4200	4600	4800